

# Comfort Series

## SUBMITTAL DATA

TOP VIEW

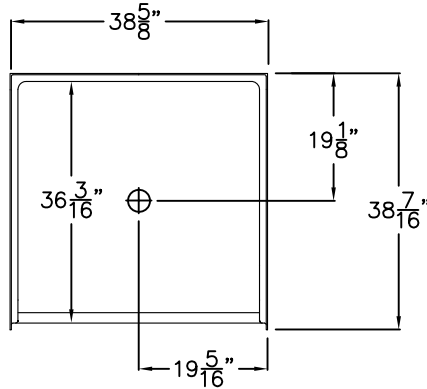

SIDE VIEW

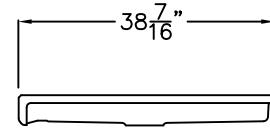

THRESHOLD DETAIL

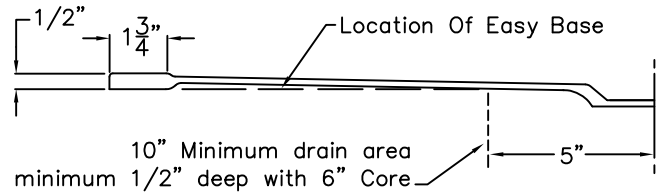

### Barrier Free Shower Pan

The shower pan shall be Laurel Mountain Whirlpools Model LM 3838 BF PAN .50, center drain.

Finished surface shall be of a sanitary-grade polyester Gelcoat exhibiting a minimal thickness of 15 dry mils, and a finished cured Barcol hardness of 80-90 as tested with ASTM D-2583.

Unit construction shall be of molded reinforced fiberglass with a minimum fiberglass content. The unit shall have inside dimensions of: 36 1/16" x 36 3/16", and have the outside dimensions of: 38 5/8" x 38 7/16" x 4.0".

The one piece pan shall meet ANSI Z124.1-2, ANSI A117.1, ADA, complies with CSA, Home Innovation Research Lab, UPC, and shall meet the requirements of the Southern Building Code.

The enclosure shall be equipped with the following installed accessories:

- 1) Low entry 1/2" threshold,
- 2) Factory installed Easy Base self sustaining bottom.

FRONT VIEW

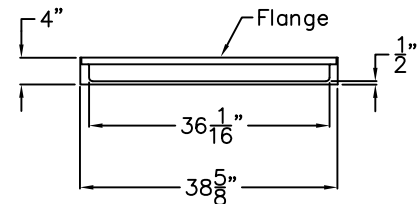

NOTE: Shower pan complies with ADA and ANSI A117.1 guidelines.

Compliance with these codes depends on walls above the pan configured with code grab bars, seat and valve package.

DUE TO THE NATURE OF THE MATERIALS INVOLVED UNIT DIMENSIONS MAY VARY ± 1/2 INCH

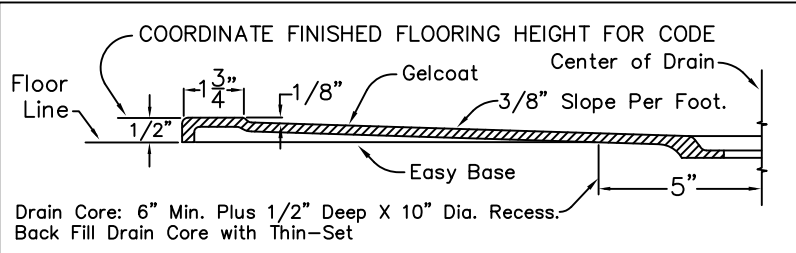

**LAUREL MOUNTAIN WHIRLPOOLS**

Drawing#: LM 3838 BF PAN .50  
Easy Base

Date: 3-31-09 Revised: 7-16-14

Quote No.

Approved By Print Name:

Approved By Signature:

Date Approved:

Rep.:

Wholesaler: